

“A Columbarium, Indianapolis, Indiana”

(the Gustav Bohn columbarium, Crown Hill Cemetery)

The Monumental News

Vol. 8, No. 2, February 1897, pp. 130

This article, which begins on the next page,
is presented on the Stone Quarries and Beyond web site.

<http://quarriesandbeyond.org/>

Peggy B. Perazzo

Email: pbperazzo@comcast.net

September 2014

A COLUMBARIUM, INDIANAPOLIS, IND.

The accompanying illustration represents a small columbarium recently erected in Crown Hill Cemetery, Indianapolis, Ind., to receive the ashes of Mr. Gustav Bohn, a man of progressive ideas, whose body according to his will was taken to Cincinnati for cremation and the ashes returned to Indianapolis to be taken care of in the above cemetery by the wish of his widow.

As there is no provision in Indianapolis for the care of such remains other than burial, it was decided to build a columbarium on a small scale, and as will be observed by the dimensions this one is not larger than some cemetery monuments of ordinary size.

In this design the upper half forms a small chamber, while the ashes are deposited in a separate hollow space in the lower solid part and covered by a slab. The ashes are contained in a copper cylindrical box, five inches in diameter by six inches high, thoroughly sealed. This is amply large enough for the remains of an adult and is in the form in which they leave the crematory sealed by the officers of the society.

The monument is built of Indiana stone, in the classic renaissance style. The small iron door in front, of Grecian design, is gilded over with leaf gold, which gives refinement to the whole design. All the ornamental work was carved from plaster models. The door is large enough to admit a full grown



the same in the family lot, or where individual wishes are to be respected, offers an appropriate solution of the question. And more than this it presents opportunities by which the monotony of the cemetery monument may be relieved. The design here illustrated speaks for itself, and it carries with it the idea of an appropriate memorial besides a permanent receptacle for the ashes of the departed.

The architects were Messrs Vonnegut

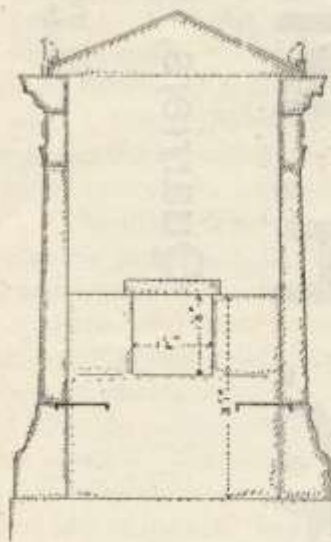

Section



Front Elevation

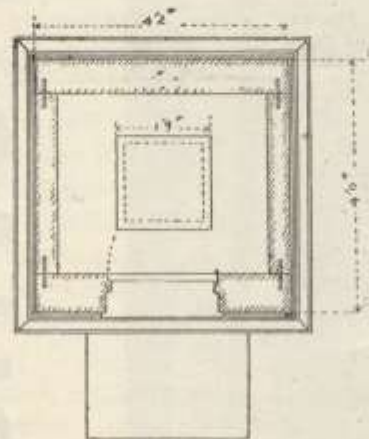

Plan

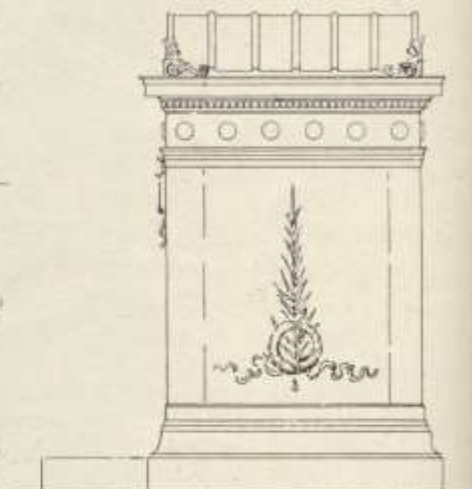

Side Elevation

person, and is kept locked; the monument could well hold the remains of an ordinary family. This method of caring for the ashes of the cremated, where it is desired for family reasons, or otherwise, to dispose of

& Bohn, Indianapolis, the monument being for the father of Mr. Bohn. It stands out well among other monuments on the top of a small hill in the cemetery mentioned in the opening paragraph.